

MOONLIGHT



BELLA FIGURA

THE WORLD'S MOST BEAUTIFUL LIGHTING

MOONLIGHT

The undeniable romance of the moonlight is the seed from which this collection grew. The light of the Moon carries an ethereal beauty and sense of mystery, an impression of this we have recreated by focusing on frosted glass and gentle swirling glass textures which evoke the meditative calm and enchanting character of this celestial body.

Moonlight embraces the spirit and energy of the much-treasured composition 'Clair de Lune' by French composer Claude Debussy, which in turn embodies poetic references of the still moonlight; sad and lovely. While the collection is in many ways a pastiche of different elements of various artistic outlets, we wanted it to remain true to the Bella Figura signature style, highly finished metal work with hand-made glass elements and luxurious silk all designed and produced in England and Italy. Art Deco influences emerge throughout this collection which further complement the romanticism of the moonlit look, with reworked motifs and ideas from the era, bringing 1920's style into 2020 and beyond.

Bella Figura has long been an avid supporter of Italian and British craftsmanship and in recent times has sought out and focused upon the best of our homegrown talent, championing English blown glass and crystal, metalsmiths and lampshade makers across the breadth of the UK. The Moonlight Collection remains engaged with our long adored and most adept Italian masters of creation, whilst showcasing the skill and finesse of our most dedicated British craftsmen and women, all of whom possess attention to detail you can feel in each and every piece.

To view full technical information for any of these designs and to view our entire product range, please visit our website at www.bella-figura.com



ERTÉ

Our whirling Erté ceiling light is proof that inspiration can evolve from anywhere. Artist Erté is perhaps best known for his instantly recognisable graphic works which encapsulate the fashions of the Arts Décoratifs period in which he worked. The dancing limbs of this generous pendant light echo the flirtatious femininity of his designs and the synchronised movement of line within his work. Select glass in Clear for a glamorous glittering look or Satin for an alluring glow to your interior setting.



ERTÉ PENDANT

CL210
SATIN GLASS & BRUSHED LIGHT BRONZE
55CM [21.6"] DIAMETER X 34CM [13.4"] HIGH

LEXINGTON

For us, the Lexington chandelier echoes the dynamism of the Art Deco architecture found on the New York avenue from which it takes its name. This bold but uncomplicated design boasts a svelte line-up of frosted glass rods, which channel light from integrated LED's concealed within the frame and emit a seductive, glamorous glow. Select one of our brushed metals to equal the soft elegance of the Satin glass or choose polished metal finishes to amplify the brilliance this piece exudes.



LEXINGTON CHANDELIER

CL131

SATIN GLASS & BRUSHED GOLD

150CM [59.5"] LONG X 27.5CM [10.9"] DEEP X 30CM [11.8"] HIGH





ELISABETTA

The crownlike beginnings of this majestic chandelier grew from a design created more than 100 years ago. A crucial update to the style being the simplification of lines which give it sleek modernity and a luxurious look. Satin glass petals and their delicately crafted clasps combine to compose a distinctive and opulent centre piece, as well as a flush mounted single tier crown perfect for slimmer rooms and hallways.



ELISABETTA CHANDELIER

CL205
SATIN GLASS & BRUSHED GOLD
100CM [39.4"] DIAMETER X 42.5CM [16.7"] HIGH



ELISABETTA FLUSH MOUNT

CL205-FM
SATIN GLASS & BRUSHED GOLD
48CM [18.9"] DIAMETER X 30CM [11.8"] HIGH

ELISABETTA

Modelled in the style of a single petal from the Elisabetta chandelier, these wall lights are minimalistic and chic with light radiating around a central facet to create a halo of soft light. The slim profile of these lights allows them to be applied to either side of a room feature adding luminosity without fuss and to areas where space is limited.



ELISABETTA LARGE WALL LIGHT

WL205-LA
SATIN GLASS & BRUSHED GOLD
11.5CM [4.5"] WIDE X 7CM [2.8"] DEEP X 56CM [22"] HIGH



ELISABETTA SMALL WALL LIGHT

WL205-SM
SATIN GLASS & BRUSHED GOLD
11.5CM [4.5"] WIDE X 7CM [2.8"] DEEP X 33CM [13"] HIGH







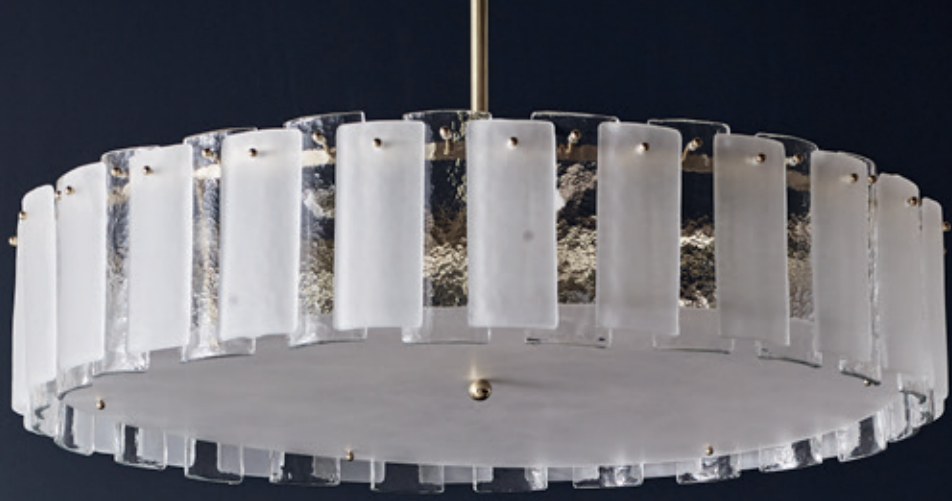

LUNAR

On our Lunar chandelier, alternating Satin and Clear glass plates describe the cyclic waxing and waning Moon phases of which we are familiar. The style of this ceiling light is informed by archives of 1920s Murano glass chandeliers and rejuvenated by a pared down, sleek approach to its form. The perfect pairing to this chandelier is our Lunar wall light, which echoes the orderly sequence of light across its face.



LUNAR CHANDELIER

CL213-RO
CLEAR & SATIN GLASS & BRUSHED GOLD
100CM [39.4"] DIAMETER X 23.5CM [9.3"] HIGH

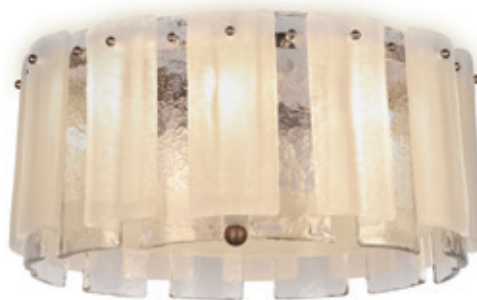

LUNAR FLUSH MOUNT

CL213-FM
CLEAR & SATIN GLASS & BRUSHED PALE GOLD
50CM [19.7"] DIAMETER X 23.5CM [9.3"] HIGH

LUNAR RECTANGULAR

The design language of our Lunar chandelier is highly versatile, therefore we are delighted to offer this design with both round and rectangular frames in an array of sizes, as well as flush mounted options. This accomplished piece can demonstrate both grandiose and understated qualities in a variety of metal finishes to adapt it to your interior scheme.



LUNAR RECTANGULAR CHANDELIER

CL213-RECT

CLEAR & SATIN GLASS & POLISHED NICKEL
125CM [49.2"] WIDE X 24CM [9.4"] DEEP X 23.5CM [9.3"] HIGH



LUNAR WALL LIGHT

WL213

SATIN GLASS & ANTIQUE RUSHED BRASS
23.5CM [9.3"] WIDE X 9CM [3.5"] DEEP X 39.5CM [15.6"] HIGH





PARCHMENT

The Parchment series brings us all the pomp and splendour of an Art Deco theatre hall with its cascading form, which emits a cosy, warming glow. The golden tones and rectilinear style of this ceiling light transports us back to The Roaring Twenties with an uncomplicated look which has stood the test of time; the parchment panels convey an essence of the classic Tiffany lighting designs with a monochromatic update to the styling. This design may be simplistic, but its boldness will still demand the limelight.



PARCHMENT CHANDELIER

CL130

PARCHMENT PANELS & BRUSHED DARK BRONZE

150CM [59.1"] WIDE X 38CM [15"] DEEP X 50CM [19.7"] HIGH



PARCHMENT WALL LIGHT

WL130

PARCHMENT PANELS & BRUSHED DARK BRONZE

18CM [7.1"] WIDE X 9CM [3.5"] DEEP X 60CM [23.6"] HIGH



REGOLITH

The crisp lines of Regolith's frame juxtapose the molten, sparkling look of the glass domes suspended beneath. The inside of the glass domes are dusted with tiny glass beads which are gently melted onto the surface. This scattering of particles is suggestive of the loose fragments which fleck the surface of the moon, termed lunar regolith. This concept aided us in the development of this rich new surface texture which when applied to a transparent material carries and amplifies the glow of the light source within. This configuration has been designed with kitchen islands in mind and its measurements are highly customisable, please contact us with your requirements.



REGOLITH CEILING LIGHT

CL206

MOONDUST GLASS & BRUSHED DARK BRONZE
150CM [59.1"] WIDE X 20CM [7.9"] DEEP X 102.5CM [40.4"] HIGH

REGOLITH

Star of the show or the ultimate accessory to the Regolith ceiling light is the Regolith wall light. The contours of its glass shade are evocative of a 1920s cloche hat, scaled down from the larger ceiling light shade with a delicate rework of the geometric lines of this design series. Blanketed in glittering grains of glass, this blend of fashion and celestial influences offers to set the room to sparkle.



REGOLITH WALL LIGHT

WL206

MOONDUST GLASS & BRUSHED DARK BRONZE
13.5CM [5.3"] WIDE X 22CM [8.7"] DEEP X 33CM [13"] HIGH





RUFFLE SMALL

The Roaring Twenties brought a break with tradition marked by great advances in design, the essence of which can be seen in the flamboyant fashion updates of the era. Ladies were adorned in extravagant and dazzling dresses with intricate beading and shimmering sequins. It was this elaborate embellishment that led us to imagine the smaller of the Ruffle ceiling light family, abundant with overlapping plates of gently waving Satin glass, each completed by a spherical finial at its centre in a finish of your choosing.



RUFFLE SMALL CHANDELIER

CL207-SM

SATIN GLASS & BRUSHED GOLD

100CM [39.4"] DIAMETER X 42CM [16.5"] HIGH

RUFFLE LARGE

Encircled by flirtatious ruffles, the larger of this design family exudes a sultry air and playful elegance. The gentle charm of the curvy glass plates was informed by ladies' fashions of the Twenties where draped fabrics and fluttery hemlines became popular. They were feminine and romantic, a style which blends in perfect harmony with our Satin glass to create a delicate, ethereal glow like moonlight.



RUFFLE LARGE CHANDELIER

CL207-LA
SATIN GLASS & BRUSHED GOLD
100CM [39.4"] DIAMETER X 25CM [9.8"] HIGH





RUFFLE WALL LIGHTS

Echoing the design language of the ceiling lights, we offer two wall light styles to complement our Ruffle collection.

A single backlit plate from our large chandelier offers a petite wall adornment which can be grouped in flowing sequences or is beautiful individually. As with the ceiling light, the gently scrunched glass is organically formed and each piece is unique. Alternatively, a cluster of our delicate, smaller plates with integrated LEDs makes for a dainty room accessory.



RUFFLE LARGE WALL LIGHT

WL207-LA

SATIN GLASS & BRUSHED GOLD

25CM [9.8"] WIDE X 10CM [3.9"] DEEP X 25CM [9.8"] HIGH



RUFFLE SMALL WALL LIGHT

WL207-SM

SATIN GLASS & BRUSHED GOLD

25CM [9.8"] WIDE X 7.8CM [3.1"] DEEP X 44CM [17.3"] HIGH





CLAIR DE LUNE

The classic romantic image of the moon illuminating rippled water. We developed a way of melting, fusing and shaping the perfect 3D illustration of this scene in glass. The undulations in the glass appear to sway and pulse as the light hits the frozen waves, all clasped by understated, sleek metalwork to keep your eyes undistracted from the play of light within. To preserve the image as we imagined, the glass is solely available in a Satin finish but the metal details can be created in a number of our house finishes; Brushed Gold, Brushed Nickel or Brushed Dark Bronze to subtly adapt the look of these distinctive designs.



CLAIR DE LUNE PENDANT

CL211-PEN

SATIN GLASS & BRUSHED DARK BRONZE

17.5CM [6.9"] WIDE X 5CM [2"] DEEP X 37CM [14.6"] HIGH



CLAIR DE LUNE OVAL WALL LIGHT

WL211-OVAL

SATIN GLASS & BRUSHED DARK BRONZE

21CM [8.3"] WIDE X 9.5CM [3.7"] DEEP X 41.5CM [16.3"] HIGH



CLAIR DE LUNE RECTANGULAR WALL LIGHT

WL211-RECT

SATIN GLASS & BRUSHED DARK BRONZE

18CM [7.1"] WIDE X 9.5CM [3.7"] DEEP X 46.5CM [18.3"] HIGH





COUNC

RENÉ

A look at Art Deco design would be incomplete without considering the work of René Lalique, but his superb glass art could not escape our notice. The René chandelier is our response to the floral motifs and frosted surface texture seen on several of his iconic sculptures. The stylised leaf impressions on this fixture are suspended on a slim oval frame which makes it the ideal feature for dining areas.



RENÉ CHANDELIER

CL214

SATIN GLASS & BRUSHED LIGHT BRONZE

125CM [49.2"] WIDE X 63CM [24.8"] DEEP X 42CM [16.5"] HIGH

MOONLIGHT

This monumental glass statue is adorned with a stylistic impression of the Moon's pitted surface. Whilst projecting a semblance of serenity and weightlessness, the Moonlight table lamp remains monolithic in stature and substance; 9kg of solid glass keeps this chic sculpture firmly grounded. Much like its wall light counterpart, the sculpted glass within this design is transformed by the introduction of light; as rays of light tumble down illuminating the patterned surface, the magnificence of its form is revealed.



MOONLIGHT TABLE LAMP

TL208

CLEAR FROSTED GLASS & POLISHED PALE GOLD
13.6CM [5.4"] WIDE X 7.5CM [3"] DEEP X 44.3CM [17.4"] HIGH





MOONLIGHT

The Moonlight wall light's glass facet is imprinted with features which resemble craters of the Moon's surface. Soft beams of light emanate from beneath the glass print, hitting the relief of the pattern and mimicking the chiaroscuro stillness of the Moon. Built-in LEDs are concealed within a sleek, minimalistic compartment with magnetic fastenings which are invisible from the outside, making sure nothing distracts the eye from the beauty of the shadows.



MOONLIGHT WALL LIGHT

WL208

CLEAR FROSTED GLASS & BRUSHED NICKEL

15CM [5.9"] WIDE X 4.5CM [1.8"] DEEP X 37CM [14.6"] HIGH

BODICE

The Bodice table lamp is the English Rose of this latest collection; a feminine personality composed of elegance and beauty with an unmistakably graceful demeanour. This table lamp is comprised of a mouth blown body of glass and a solid, spun brass neck, both deftly crafted in the south of England.



BODICE TABLE LAMP

TL663

STORM & PEWTER

16CM [6.3"] WIDE X 12CM [4.7"] DEEP X 36.5CM [14.4"] HIGH
SHOWN WITH 12" OVAL DRUM SHADE



BODICE TABLE LAMP

TL663

INDIGO & ANTIQUE BRASS

16CM [6.3"] WIDE X 12CM [4.7"] DEEP X 36.5CM [14.4"] HIGH
SHOWN WITH 12" OVAL DRUM SHADE



BODICE TABLE LAMP

TL663

MAHOGANY & ANTIQUE BRASS

16CM [6.3"] WIDE X 12CM [4.7"] DEEP X 36.5CM [14.4"] HIGH
SHOWN WITH 12" OVAL DRUM SHADE

*Total Height with 12" Oval Drum Shade: 58.2cm [22.9"]
As these glass lamps are handmade by our artisans in England,
they may vary slightly in dimension and appearance.
These glass finishes are translucent.*





BODICE

The Bodice table lamp is the English Rose of this latest collection; a feminine personality composed of elegance and beauty with an unmistakably graceful demeanour. This table lamp is comprised of a mouth blown body of glass and a solid, spun brass neck, both deftly crafted in the south of England



BODICE TABLE LAMP

TL663
NIGHTWATCH & POLISHED BRASS
16CM [6.3"] WIDE X 12CM [4.7"] DEEP X 36.5CM [14.4"] HIGH
SHOWN WITH 12" OVAL DRUM SHADE



BODICE TABLE LAMP

TL663
BALLET & PEWTER
16CM [6.3"] WIDE X 12CM [4.7"] DEEP X 36.5CM [14.4"] HIGH
SHOWN WITH 12" OVAL DRUM SHADE



BODICE TABLE LAMP

TL663
RAINCLOUD & POLISHED NICKEL
16CM [6.3"] WIDE X 12CM [4.7"] DEEP X 36.5CM [14.4"] HIGH
SHOWN WITH 12" OVAL DRUM SHADE



BODICE TABLE LAMP

TL663
INK & POLISHED NICKEL
16CM [6.3"] WIDE X 12CM [4.7"] DEEP X 36.5CM [14.4"] HIGH
SHOWN WITH 12" OVAL DRUM SHADE

*Total Height with 12" Oval Drum Shade: 58.2cm [22.9"]
As these glass lamps are handmade by our artisans in England,
they may vary slightly in dimension and appearance.
These glass finishes are opaque.*



NILSSEN

Although this series of designs has totally evolved, the roots of the design are centred around the work of silversmith Wiwen Nilssen. Considering the corners and facets of his tableware creations, we have softened the geometry of Nilssen's iconic design language and arrived at these stacking glass elements. We have infused their cores with richly bubbled detailing which glitter brilliantly when illuminated.



NILSSEN FLOOR LAMP

FL212
BUBBLE GLASS & ANTIQUE BRUSHED BRASS
25.5CM [10"] WIDE X 25.5CM [10"] DEEP X 145CM [57.1"] HIGH



NILSSEN WALL LIGHT

WL212
BUBBLE GLASS & BRUSHED GOLD
20.3CM [8"] WIDE X 15CM [5.9"] DEEP X 40CM [15.7"] HIGH
DIMENSIONS INCLUDING 8" OVAL SHADE



NILSSEN TABLE LAMP

TL212
BUBBLE GLASS & POLISHED NICKEL
25.5CM [10"] WIDE X 25.5CM [10"] DEEP X 145CM [57.1"] HIGH

BRANDT

The Brandt series throws us back into the Art Deco era with a sleek and confident design inspired by one of the most accomplished metalsmiths of the time, Edgar Brandt. The sweeping lines of the original motif are made current by simplification, creating this impressive and highly adaptable design, which gleams as the light falls upon its surface. The table lamp and floor lamp in this series are made with a solid glass base, in your choice of a statement Gloss Black or soft, ethereal Satin which echoes the celestial look which runs throughout the Moonlight collection.



BRANDT FLOOR LAMP

FL209
SATIN GLASS & BRUSHED GOLD
35CM [13.8"] WIDE X 25CM [9.8"] DEEP X 149.5CM [58.9"] HIGH

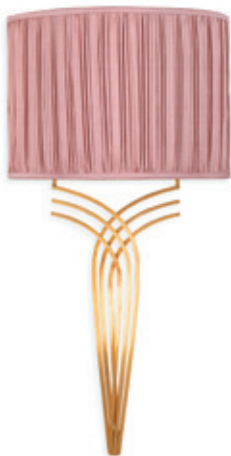

BRANDT WALL LIGHT

WL209
BRUSHED GOLD
18CM [7.1"] WIDE X 6.5CM [2.6"] DEEP X 51CM [20.1"] HIGH



BRANDT TABLE LIGHT

TL209
SATIN GLASS & BRUSHED DARK BRONZE
17.8CM [7"] WIDE X 12CM [4.7"] DEEP X 47.5CM [18.7"] HIGH



SHADES

Bella Figura is proud to offer our diverse range of custom shades, shipped in only 10 working days. Direct from our Suffolk workshop, we provide our clients with the following options;

- 8 standard shade shapes in 64 sizes, or to your bespoke dimensions.
- Luxury house silks sourced exclusively from Bennett Silks and James Hare. Both of these English companies create the precise combination of colour, fabric strength and flexibility to form the perfect shade.
- Over 600 house silks in Dupion, Crepe Satin, Linen or Velvet fabrics plus the option of COM (customer's own material).
- New this year, the addition of pleated fabric to our range. Available in ten house silk colours, the pleated silk is bonded to our shade card creating a robust and contemporary drum shade.
- A choice of internal linings in either white, cream, champagne, gold or silver card. The white and cream linings diffuse a portion of the light through the fabric when lit, as opposed to the champagne, gold and silver linings which are opaque.
- Shipment from our UK warehouse within 10 working days of order confirmation. Bespoke dimensions may take longer: please get in touch to find out more.

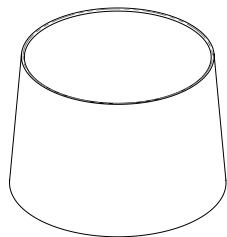

MELTON SHADE

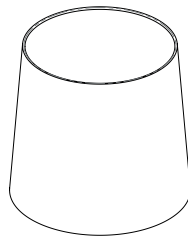

WALTON SHADE

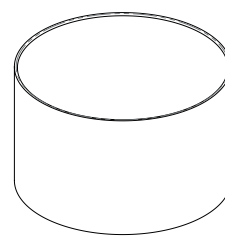

DRUM SHADE

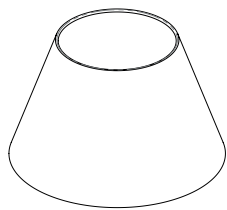

EMPIRE SHADE

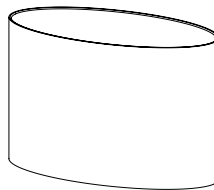

OVAL SHADE

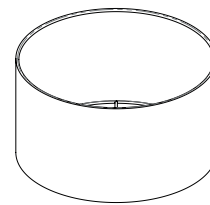

SHORT DRUM SHADE

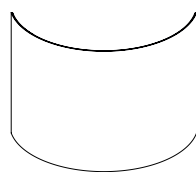

HALF MOON SHADE

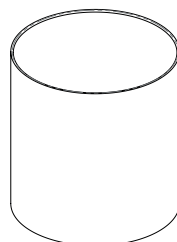

TALL DRUM SHADE

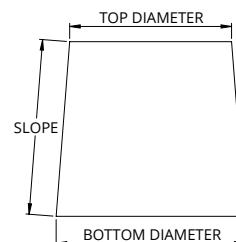

BESPOKE SHADE

For full information on our shades and silks please visit our website.



CONTACT / VISIT US

We would love to host you at our flagship showroom, located at the heart of Design Centre Chelsea Harbour.
Please get in touch with us to arrange a visit, or just to talk to one of our Sales team.

LONDON SHOWROOM

G24 Ground Floor, Centre Dome
Chelsea Harbour Design Centre
Lots Road, Chelsea
London SW10 0XE
Tel: +44 (0)207 376 4564
showroom@bella-figura.com

ADMINISTRATION & HEAD OFFICE

Suite 301 Harbour Yard
Lots Road, Chelsea
London SW10 0XD
Tel: +44 (0)207 349 1320

WAREHOUSE & WORKSHOP

Unit 17 Clopton Park
Woodbridge
Suffolk IP13 6QT
Tel: +44 (0)139 433 7512

UK SOUTHERN AREA SALES MANAGER

Tom Perry
Southern England & Wales
Tel: 07927 549611
tom@bella-figura.com

UK NORTHERN AREA SALES MANAGER

Chris Gilbert
Northern England, Scotland,
Northern Ireland & Eire
Tel: 07734 391595
chris@bella-figura.com

EUROPE & REST OF THE WORLD SALES

Hannah Kick
European & ROW Export Sales Manager
Suite 301 Harbour Yard
Lots Road, Chelsea
London SW10 0XD
Tel: +44 (0)207 349 1324
Mobile Number: +44(0)792 754 9613
hannah@bella-figura.com
export@bella-figura.com

GERMANY & AUSTRIA SALES

Wolfgang & Till Simons GBR
Simons Concepts
Hirtenweg 14
82031 Gruenwald
Germany
Tel: Till +49 (0)176 6463 5014
Mobile Number: Wolfgang +49 (0)171 763 1551
till.simons@simons-concepts.de
ws@simons-concepts.com

NORTH AMERICA SALES

Veronica Felstead-Todd
VP North & Central America
Houston, Texas
Tel: 832-296-5015
veronica@bella-figura.com
usa@bella-figura.com

For details of your nearest showroom in North America
please see our website www.bella-figura.com

www.bella-figura.com



Bella Figura Ltd
G24 Chelsea Harbour Design Centre
Lots Road, London SW10 0XE

Tel: +44(0)207 376 4564

Email: showroom@bella-figura.com

Web: www.bella-figura.com